

# Photo Encoder and Tacho



- Ultra Miniaturized and Ultra Light Incremental Photo Encoder
- High Resolution  
16mm Dia., 1000P/R  
30mm Dia., 2000P/R
- Open Collector Output

## What is Chiba Precision?

Chiba Precision is a manufacturer specialized for the miniaturized high performance rotary components, including coreless DC servomotors, brushless DC motors, miniaturized AC servomotors, linear actuators and custom design products. Since establish 1979, our technology has been applied across a broad range of state-of-the-art applications, where high precision and high accuracy motion control must be needed.

## Tachometer Generator: 23mm Dia.



M2.6x0.45 3-300Depth BQ 5P  
φ=22.0G1/8 FD

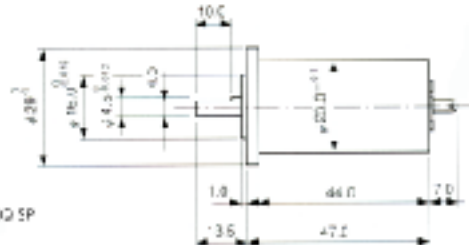

TG-234401P  
TG-234402P

Configuration

Parameter	Unit	TG-234401P	TG-234402P	Remarks
Output Voltage	V/1000rpm	3+/-10%	6+/-10%	
Linearity	%		0.2max	
P-P Ripple (Test Circuit)	%		3.0max	
RMS Ripple	%		0.5max	
Ripple Frequency	Cycle/Rev.		11	
Bi-directional Error	%max		0.5	
Armature Resistance	Ohm	90	280	
Armature Inductance	mH	0.8	3.3	
Armature Inertia	g-cm <sup>2</sup>		2.0	
Friction Torque	gf-cm		20	
Temp. Coefficient of Generated Voltage	%/°C		-0.03	
Insulation Resistance	MOhm		10(min)	
Operating Temp. Range	°C		-10/+60	
Max. Temp. Rise of Armature Winding	°C		130	
Speed Range	rpm		7000(max)	
Thrust Clearance	mm		0.025 - 0.1	
Radial Clearance	mm max		0.038	
Shaft Run-Out (TIR)	mm max		0.05	
Weight	g		110	

CHIBA PRECISION CO.,LTD.