

# 遊星歯車減速機 Planetary Gearheads

シチズン千葉精密株式会社  
CITIZEN CHIBA PRECISION CO., LTD.

SAP :  $\phi 32$

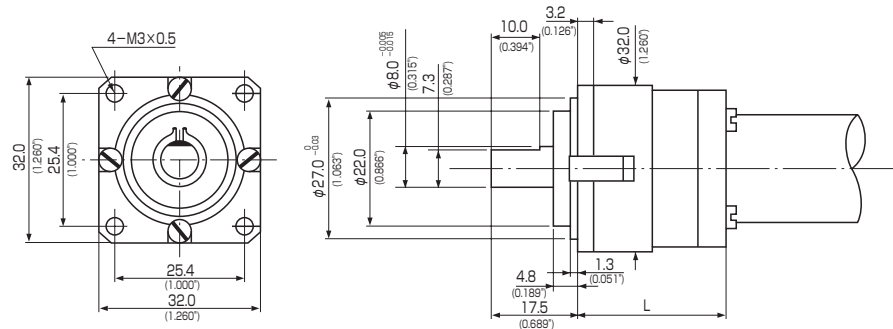

Unit : mm (in)

## ギア特性 Gear Specifications

減速比 Reduction Ratio	許容出力トルク Permissible Output Torque			許容出力 Permissible Output W	最大入力回転数 Max Speed rpm	効 率 Efficiency %	許容ラジアル荷重 Permissible Radial Load N(kgf)	許容スラスト荷重 Permissible Thrust Load N(kgf)	バックラッシュ Backlash deg	寸法 L Length		重 量 Weight g
	Nm	kgf·cm	oz-in							mm	inch	
1/4.00	0.392	4	55.55	13.0	10000	85	50.0 (5.1)	40.0 (4.0)	1.5	24.8	0.976	110
1/6.00	0.392	4	55.55	13.0	10000	85	50.0 (5.1)	40.0 (4.0)	1.5	24.8	0.976	110
1/16.00	0.981	10	138.87	10.0	10000	72	55.0 (5.6)	70.0 (7.1)	1.5	28.9	1.138	130
1/24.00	0.981	10	138.87	10.0	10000	72	55.0 (5.6)	70.0 (7.1)	1.5	28.9	1.138	130
1/36.00	0.981	10	138.87	10.0	10000	72	55.0 (5.6)	70.0 (7.1)	1.5	28.9	1.138	130
1/64.00	1.961	20	277.74	8.0	10000	61	65.0 (6.6)	120.0 (12.2)	1.5	34.5	1.358	160
1/96.00	1.961	20	277.74	8.0	10000	61	65.0 (6.6)	120.0 (12.2)	1.5	34.5	1.358	160
1/144.00	1.961	20	277.74	8.0	10000	61	65.0 (6.6)	120.0 (12.2)	1.5	34.5	1.358	160
1/216.00	1.961	20	277.74	8.0	10000	61	65.0 (6.6)	120.0 (12.2)	1.5	34.5	1.358	160
1/256.00	4.707	48	666.59	6.5	10000	52	75.0 (7.6)	200.0 (20.4)	1.5	40.5	1.594	190
1/384.00	4.707	48	666.59	6.5	10000	52	75.0 (7.6)	200.0 (20.4)	1.5	40.5	1.594	190
1/576.00	4.707	48	666.59	6.5	10000	52	75.0 (7.6)	200.0 (20.4)	1.5	40.5	1.594	190
1/864.00	4.707	48	666.59	5.5	10000	52	75.0 (7.6)	200.0 (20.4)	1.5	40.5	1.594	190
1/1296.00	4.707	48	666.59	4.0	10000	52	75.0 (7.6)	200.0 (20.4)	1.5	40.5	1.594	190

SFP :  $\phi 42$

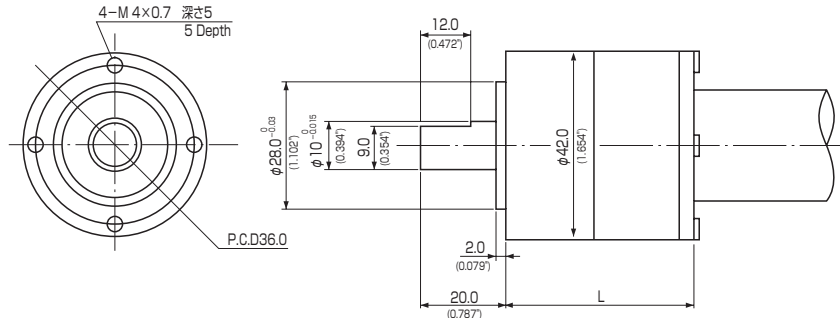

Unit : mm (in)

## ギア特性 Gear Specifications

減速比 Reduction Ratio	許容出力トルク Permissible Output Torque			許容出力 Permissible Output W	最大入力回転数 Max Speed rpm	効 率 Efficiency %	許容ラジアル荷重 Permissible Radial Load N(kgf)	許容スラスト荷重 Permissible Thrust Load N(kgf)	バックラッシュ Backlash deg	寸法 L Length		重 量 Weight g
	Nm	kgf·cm	oz-in							mm	inch	
1/5.43	1.471	15	208.31	16.0	7000	90	100.0 (10.2)	60.0 (6.1)	1.5	36.5	1.437	190
1/20.73	2.942	30	416.62	14.5	7000	81	120.0 (12.2)	120.0 (12.2)	1.5	43.8	1.724	230
1/29.47	2.942	30	416.62	14.5	7000	81	120.0 (12.2)	120.0 (12.2)	1.5	43.8	1.724	230
1/79.24	5.884	60	833.23	13.0	7000	73	150.0 (15.3)	200.0 (20.4)	1.5	53.5	2.106	290
1/112.52	5.884	60	833.23	13.0	7000	73	150.0 (15.3)	200.0 (20.4)	1.5	53.5	2.106	290
1/160.00	5.884	60	833.23	13.0	7000	73	150.0 (15.3)	200.0 (20.4)	1.5	53.5	2.106	290
1/302.15	9.807	100	1388.72	12.0	7000	66	180.0 (18.3)	300.0 (30.6)	1.5	63.8	2.512	350
1/429.62	9.807	100	1388.72	12.0	7000	66	180.0 (18.3)	300.0 (30.6)	1.5	63.8	2.512	350
1/610.82	9.807	100	1388.72	11.5	7000	66	180.0 (18.3)	300.0 (30.6)	1.5	63.8	2.512	350
1/868.44	9.807	100	1388.72	8.0	7000	66	180.0 (18.3)	300.0 (30.6)	1.5	63.8	2.512	350