

SJP : φ18

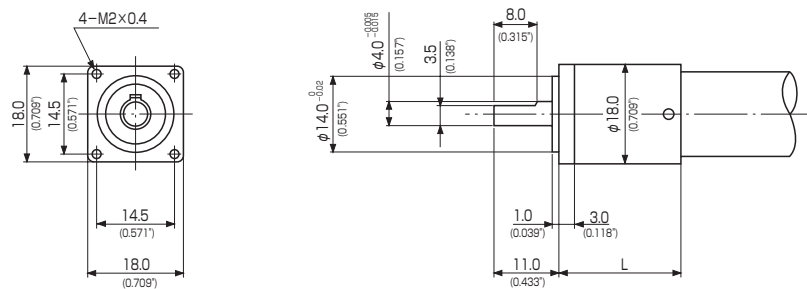

Unit : mm (in)

ギア特性 Gear Specifications

減速比 Reduction Ratio	許容出力トルク Permissible Output Torque			許容出力 Permissible Output	最大入力回転数 Max Speed	効 率 Efficiency	許容ラジアル荷重 Permissible Radial Load	許容スラスト荷重 Permissible Thrust Load	バックラッシュ Backlash	寸法 L Length		重 量 Weight
	Nm	kgf·cm	oz-in							mm	inch	
1/4.00	0.127	1.3	18.05	4.0	12000	80	10.0 (1.0)	10.0 (1.0)	1.5	19.9	0.783	26
1/6.00	0.127	1.3	18.05	4.0	12000	80	10.0 (1.0)	10.0 (1.0)	1.5	19.9	0.783	26
1/16.00	0.265	2.7	37.50	3.2	12000	64	11.0 (1.1)	15.0 (1.5)	1.5	22.9	0.902	31
1/24.00	0.265	2.7	37.50	3.2	12000	64	11.0 (1.1)	15.0 (1.5)	1.5	22.9	0.902	31
1/36.00	0.265	2.7	37.50	3.2	12000	64	11.0 (1.1)	15.0 (1.5)	1.5	22.9	0.902	31
1/64.00	0.569	5.8	80.55	2.5	12000	51	12.0 (1.2)	30.0 (3.0)	1.5	26.7	1.051	38
1/96.00	0.569	5.8	80.55	2.5	12000	51	12.0 (1.2)	30.0 (3.0)	1.5	26.7	1.051	38
1/144.00	0.569	5.8	80.55	2.5	12000	51	12.0 (1.2)	30.0 (3.0)	1.5	26.7	1.051	38
1/216.00	0.569	5.8	80.55	2.5	12000	51	12.0 (1.2)	30.0 (3.0)	1.5	26.7	1.051	38
1/256.00	1.177	12	166.65	2.0	12000	41	13.0 (1.3)	50.0 (5.0)	1.5	30.9	1.217	45
1/384.00	1.177	12	166.65	2.0	12000	41	13.0 (1.3)	50.0 (5.0)	1.5	30.9	1.217	45
1/576.00	1.177	12	166.65	2.0	12000	41	13.0 (1.3)	50.0 (5.0)	1.5	30.9	1.217	45
1/864.00	1.177	12	166.65	1.5	12000	41	13.0 (1.3)	50.0 (5.0)	1.5	30.9	1.217	45
1/1296.00	1.177	12	166.65	1.1	12000	41	13.0 (1.3)	50.0 (5.0)	1.5	30.9	1.217	45

SMP : φ25

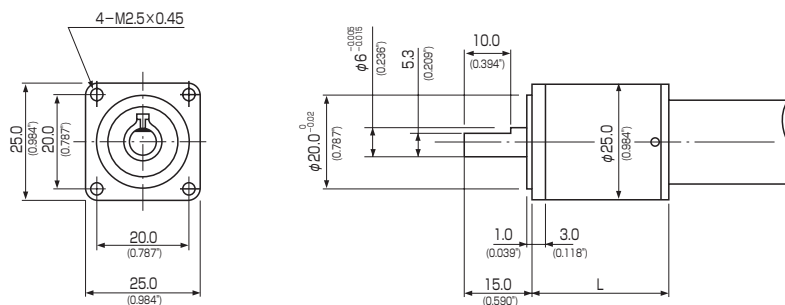

Unit : mm (in)

ギア特性 Gear Specifications

減速比 Reduction Ratio	許容出力トルク Permissible Output Torque			許容出力 Permissible Output	最大入力回転数 Max Speed	効 率 Efficiency	許容ラジアル荷重 Permissible Radial Load	許容スラスト荷重 Permissible Thrust Load	バックラッシュ Backlash	寸法 L Length		重 量 Weight
	Nm	kgf·cm	oz-in							mm	inch	
1/4.00	0.245	2.5	34.72	8.0	10000	85	35.0 (3.5)	30.0 (3.0)	1.5	25.3	0.996	63
1/6.00	0.245	2.5	34.72	8.0	10000	85	35.0 (3.5)	30.0 (3.0)	1.5	25.3	0.996	63
1/16.00	0.588	6	83.32	6.0	10000	72	40.0 (4.0)	50.0 (5.1)	1.5	29.7	1.169	75
1/24.00	0.588	6	83.32	6.0	10000	72	40.0 (4.0)	50.0 (5.1)	1.5	29.7	1.169	75
1/36.00	0.588	6	83.32	6.0	10000	72	40.0 (4.0)	50.0 (5.1)	1.5	29.7	1.169	75
1/64.00	1.177	12	166.65	5.0	10000	61	50.0 (5.1)	90.0 (9.1)	1.5	35.3	1.390	95
1/96.00	1.177	12	166.65	5.0	10000	61	50.0 (5.1)	90.0 (9.1)	1.5	35.3	1.390	95
1/144.00	1.177	12	166.65	5.0	10000	61	50.0 (5.1)	90.0 (9.1)	1.5	35.3	1.390	95
1/216.00	1.177	12	166.65	5.0	10000	61	50.0 (5.1)	90.0 (9.1)	1.5	35.3	1.390	95
1/256.00	2.942	30	416.62	4.0	10000	52	55.0 (5.6)	150.0 (15.3)	1.5	41.1	1.618	115
1/384.00	2.942	30	416.62	4.0	10000	52	55.0 (5.6)	150.0 (15.3)	1.5	41.1	1.618	115
1/576.00	2.942	30	416.62	4.0	10000	52	55.0 (5.6)	150.0 (15.3)	1.5	41.1	1.618	115
1/864.00	2.942	30	416.62	3.5	10000	52	55.0 (5.6)	150.0 (15.3)	1.5	41.1	1.618	115
1/1296.00	2.942	30	416.62	2.5	10000	52	55.0 (5.6)	150.0 (15.3)	1.5	41.1	1.618	115